

# All Paint Color

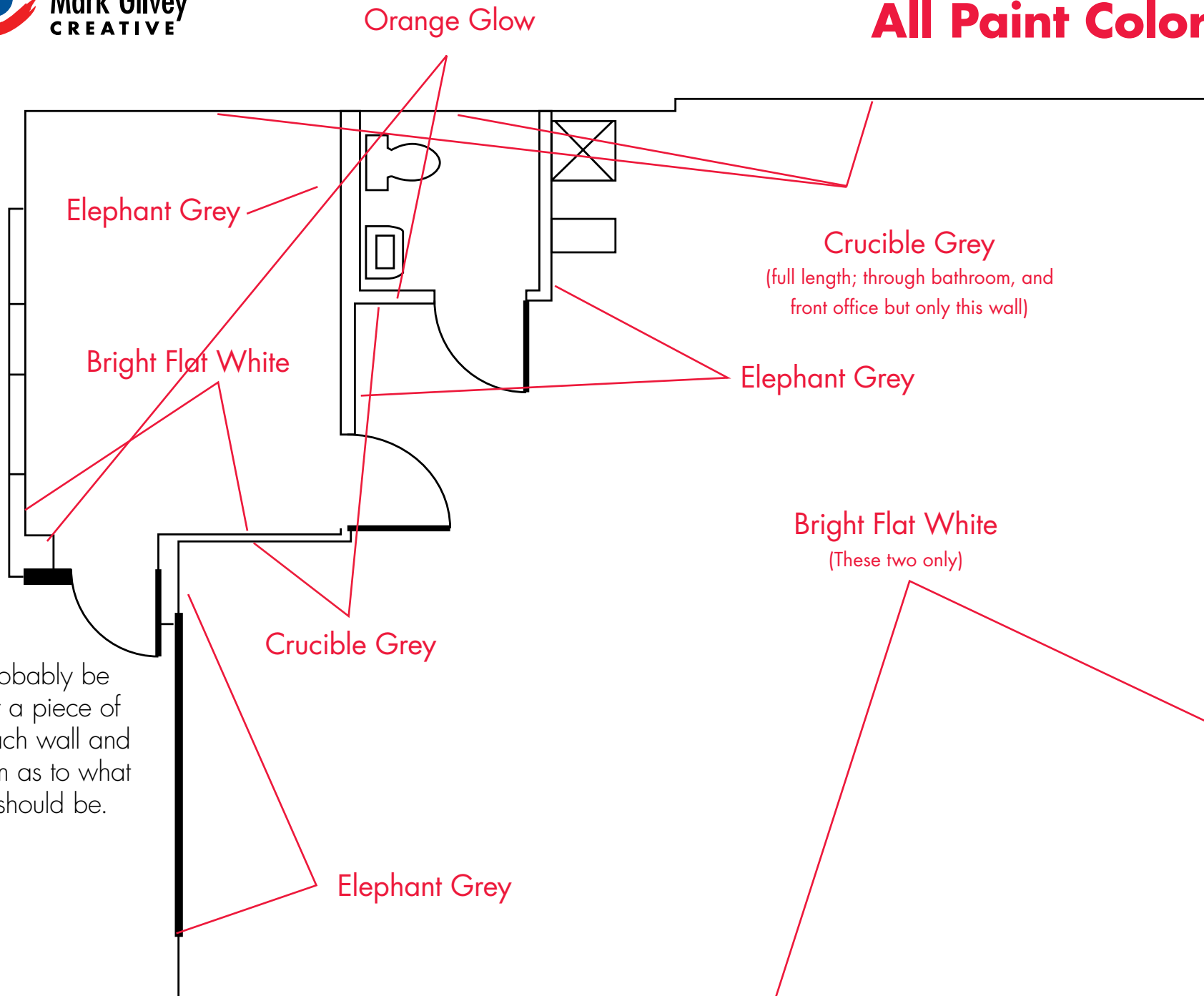

It would probably be best if I put a piece of tape on each wall and labeled them as to what color they should be.

**IMPORTANT**

The numbers only measure from a corner to the end of the usable wall. They do not include door frames because I won't put anything in front of a door frame. Add 2" if you want to include that.

Also, the drawing is based off the original that PSBP gave me and not actual measurements.

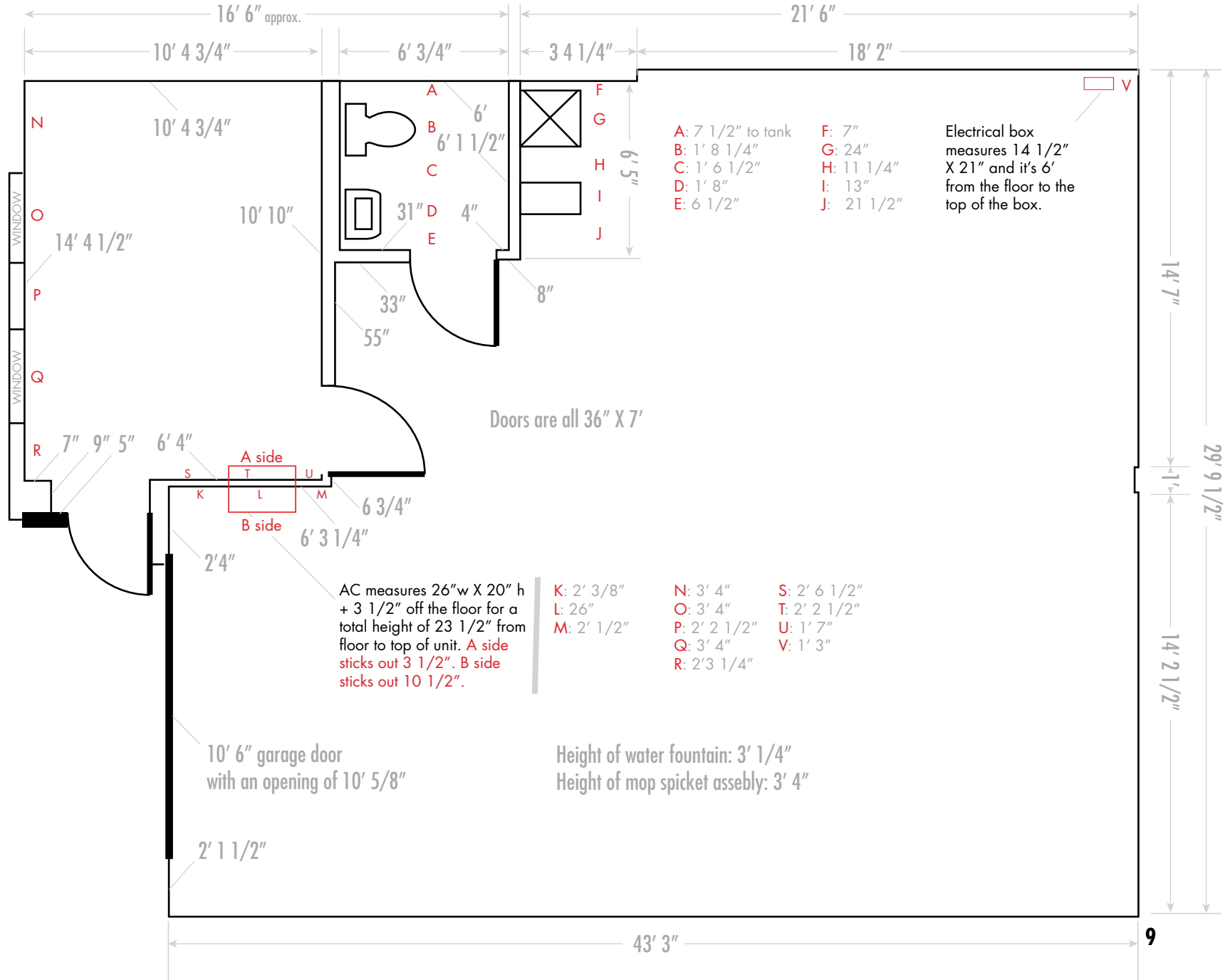



These are the colors. The light grey on the far left is darker than the original grey I selected. I don't recall what we came up with but it was decided that darker greys would help the wall art pop while keeping the studio neutral in color.

I still want to have two tones along the wall that is the backside of the front office (in studio area) but I'm replacing the green that Monirom selected on the basis that Patrick highly recommend I stay neutral for a photo studio. Having it a different shade of Grey will give me my two tone contrast I was looking for.

I'm altering the paint on the door and the trim from what I originally said. The landlord will not allow me to paint the doors so I've decided to not paint the door trim as well.

**I will paint this room.**

*Elephant Grey  
(semi-gloss)*

*Orange Glow  
(semi-gloss)*

*Flat White*

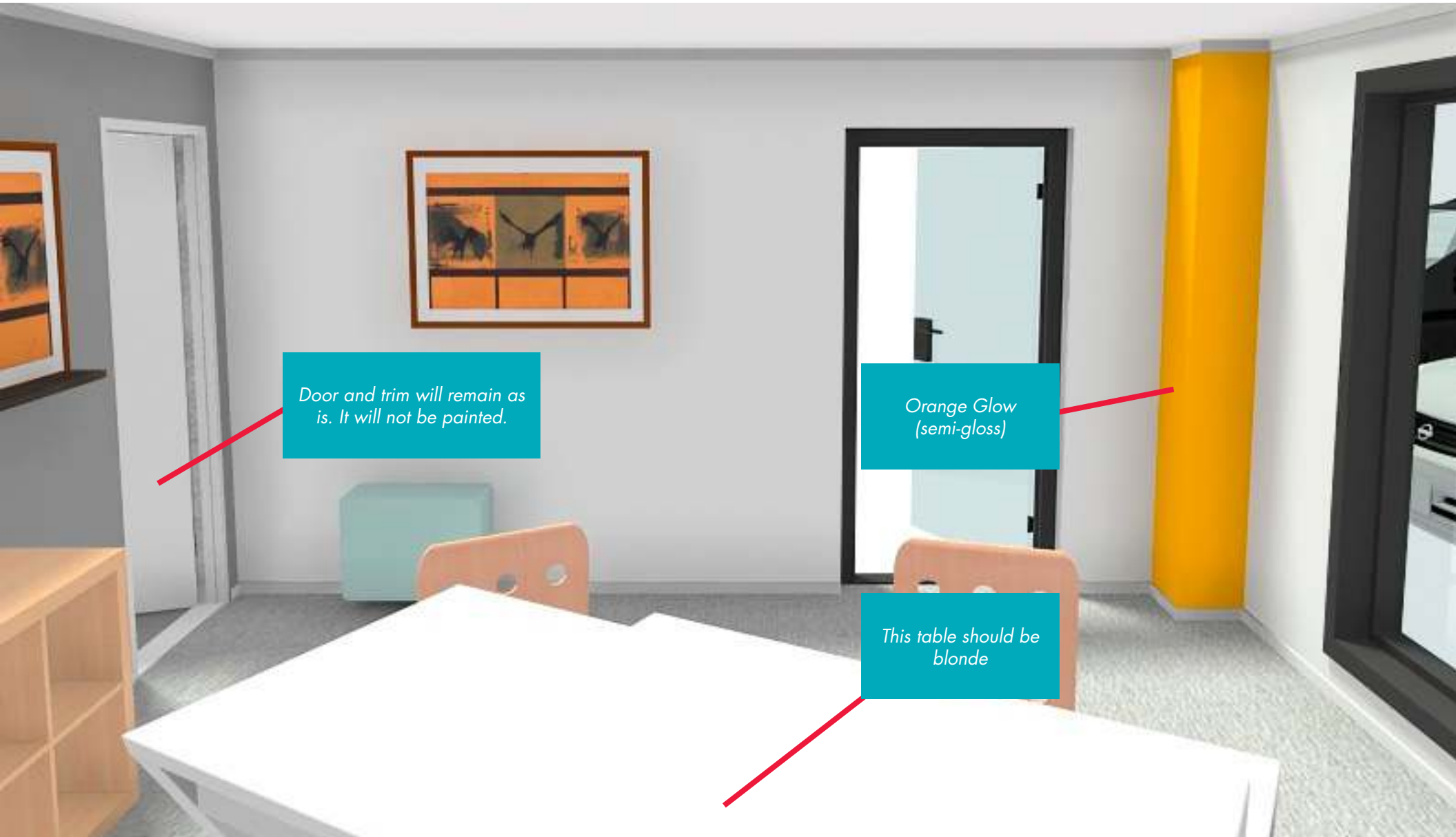

*Door and trim will remain as is. It will not be painted.*

*Orange Glow (semi-gloss)*

*This table should be blonde*

This is looking in from the front door. Currently the walls are an eggshell white. I want to change them to Flat White.

The wall at the end uses the Crucible Grey. That means there will be two grey walls in the front office. The seckon wall, out of the right side of the photo, will be Elephant Grey.



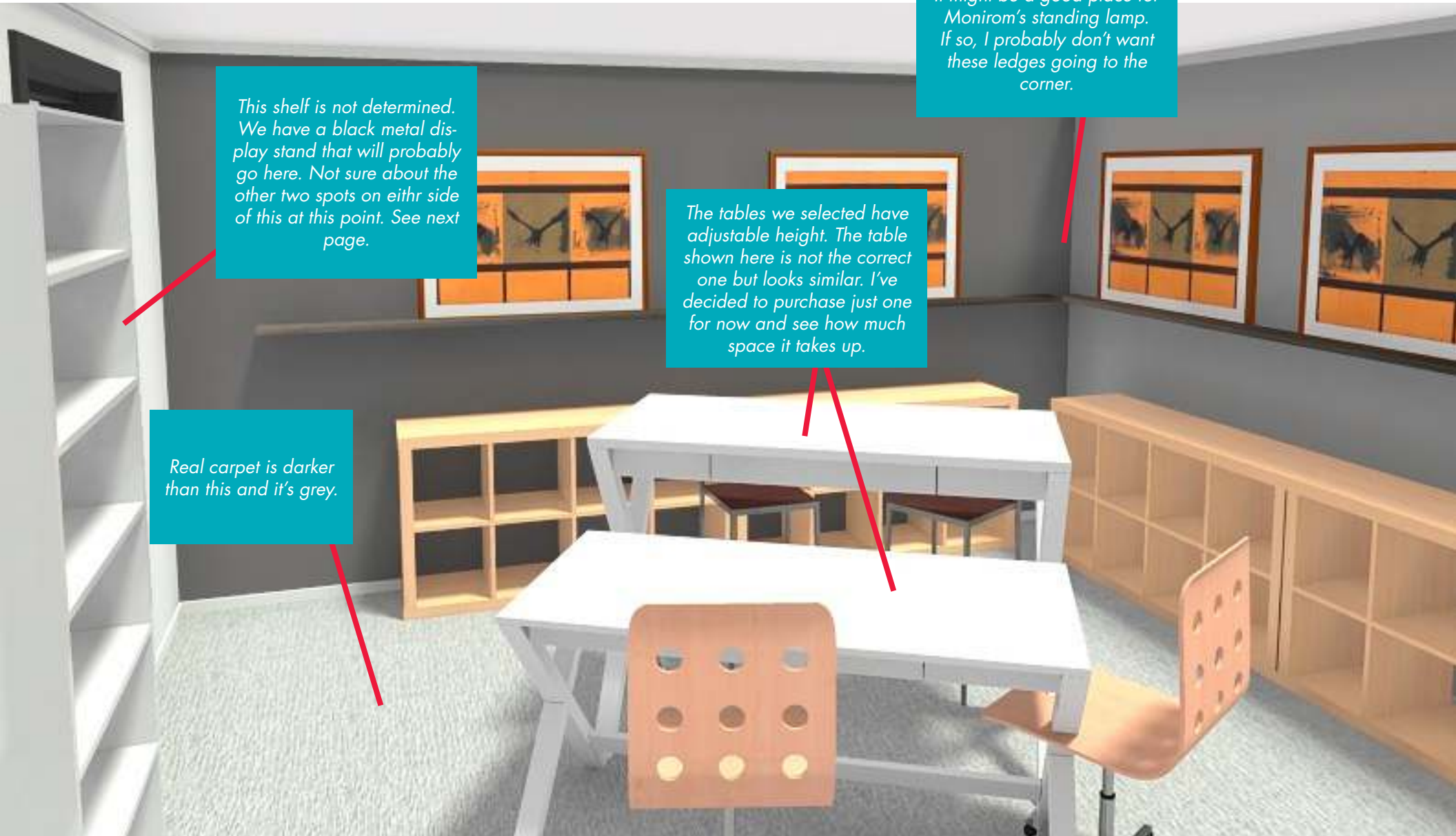

*This shelf is not determined. We have a black metal display stand that will probably go here. Not sure about the other two spots on either side of this at this point. See next page.*

*Real carpet is darker than this and it's grey.*

*The tables we selected have adjustable height. The table shown here is not the correct one but looks similar. I've decided to purchase just one for now and see how much space it takes up.*

*I'm not sure about this corner. It might be a good place for Monirom's standing lamp. If so, I probably don't want these ledges going to the corner.*

## Front Office Furniture

### QUESTION:

*Should I use these picture shelves or actually nail them on hooks to the wall?*



*This display stand would also go in the front office.*



*These ledges would be used wherever I would have photos. No photos would be nailed into the wall except maybe the ones I wanted to put in the bathroom.*



*As you walk into the studio, this cabinet is in front of you; I was looking at this cabinet to go across that wall and the wall that is painted with Crucible grey. Color would be blonde. I'd have to build a 6" box to raise them to a better height.*



## Front Office Furniture



*This table will stand high if needed to. So we were thinking of getting a couple of the tall chairs at left. They only come in black and white which is fine. My wife has a broken one right now but uses it at her display booth at art shows. A white one for me would work for my display booth.*

*The version of this table we are looking at has blonde table top and white legs. They don't make blonde legs for this model.*



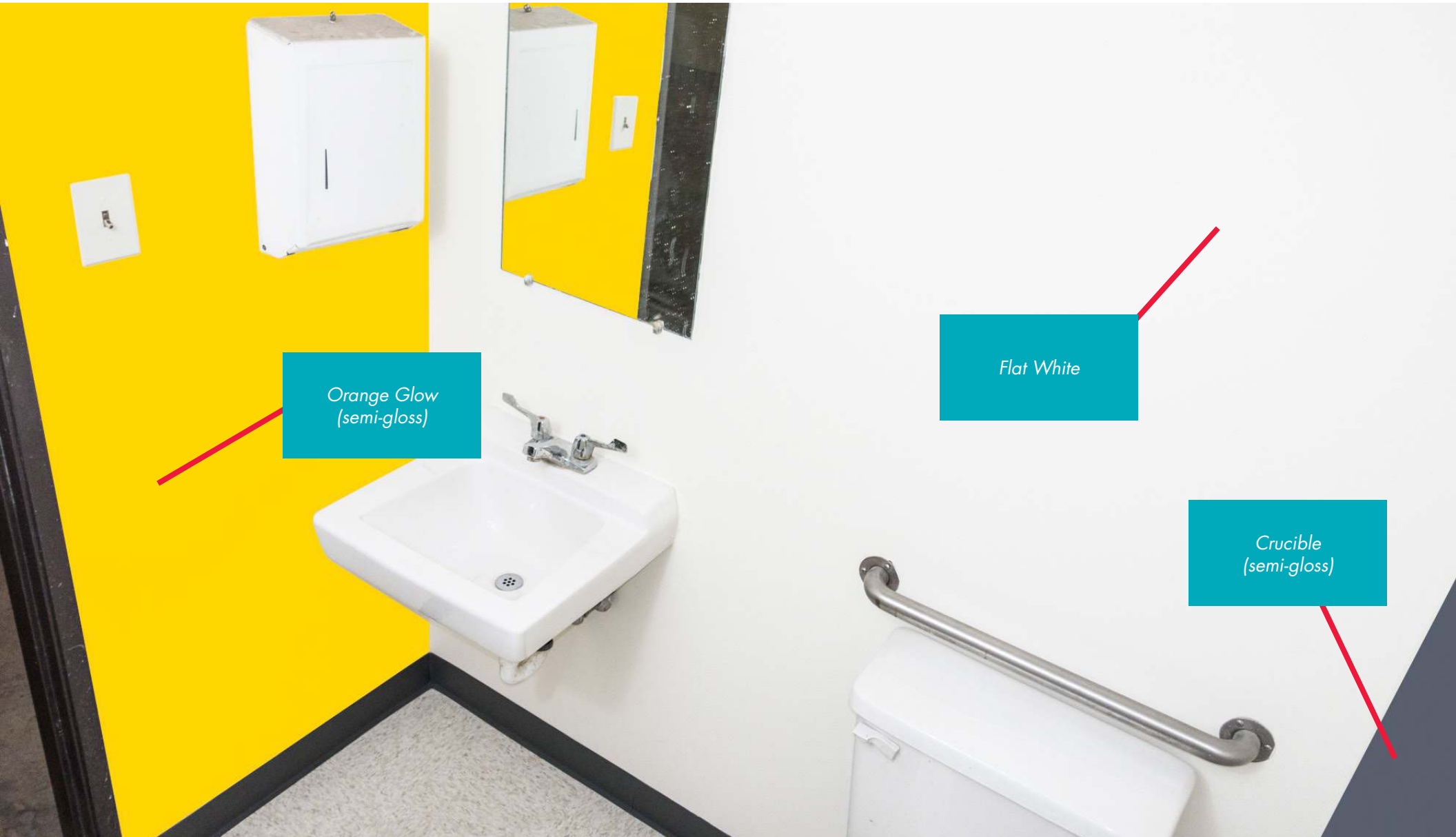



*This is simulating a 3 shelf stand I have. The measurements in this render are off. There is too much space between sink and toilet. About all you can fit is this 3-shelf stand in reality.*



*I have decided against these flip-out storage cabinets as I might have enough space in one of the other cubby cabinets.*

The grey on the right wall is Crucible.  
It's the same grey that runs the full length  
of the studio on that side only.



Flat White



Crucible  
(semi-gloss)



## Bathroom Furniture

### QUESTION:

*The storage container at right is available in black or white. It will go on the white wall across from the toilet. Which color?*

*This will be a place to store cleaning supplies.*



*Marie suggested the three-shelf rack inbetween the toilet and the sink. We also wanted to replace the mirror. I'm thinking we get one that is as long as the wall the current one is on and place some small shelves below it. I think the yellow one on the top (right) is the same color as the wall.*



This is easy to figure out; if you look one direction you only see walls with Elephant Grey. If you look the other way, you get Crucible grey. Two walls are Elephant grey and the other two walls are Crucible grey.

The door is Orange Glow on one side and Crucible on the other. Paint the edges Crucible as well.

Again, on the outside of the bathroom, when the door is closed, both the trim and the door will be Crucible. On the inside, the trim and the door will be Orange Glow

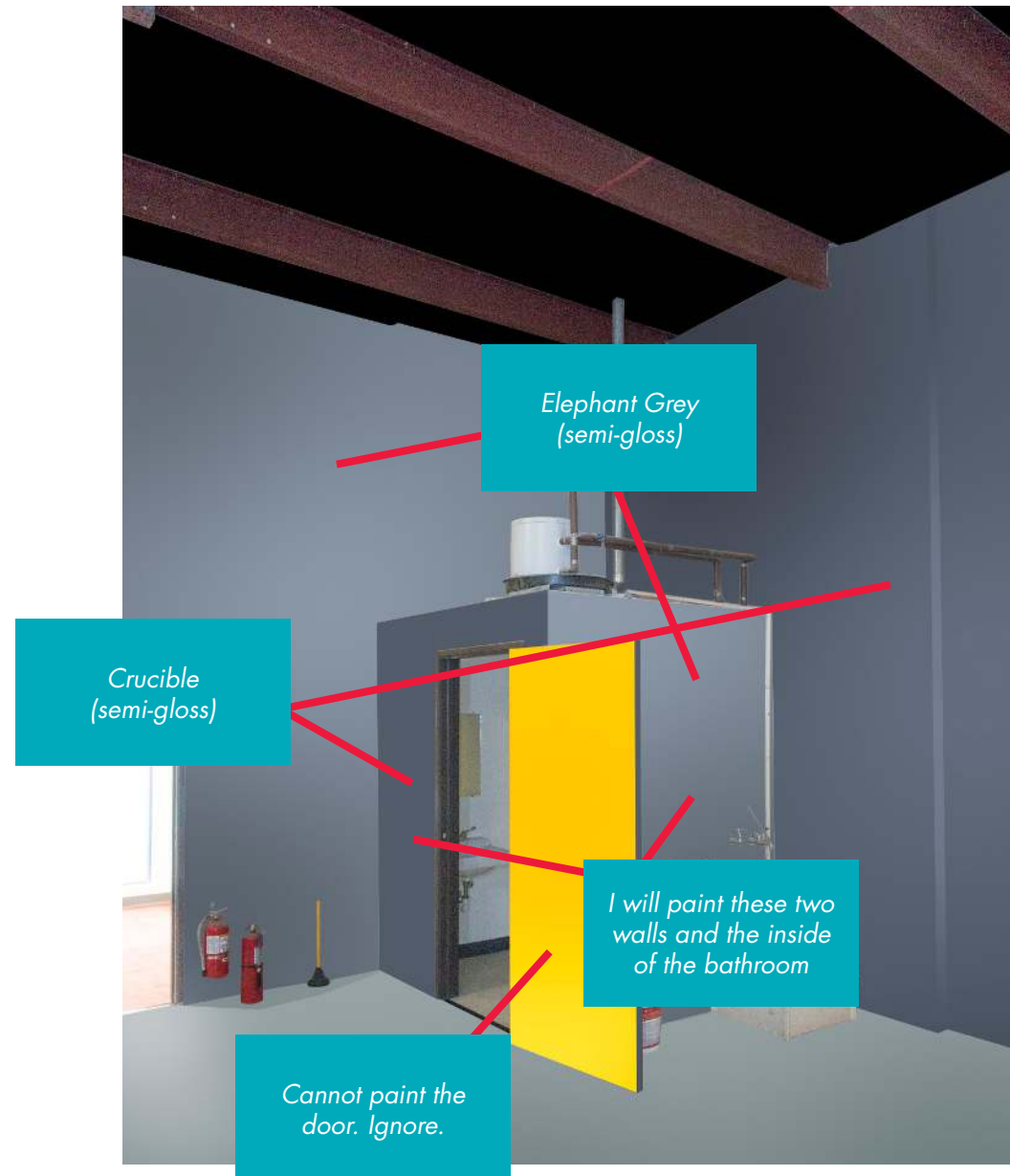

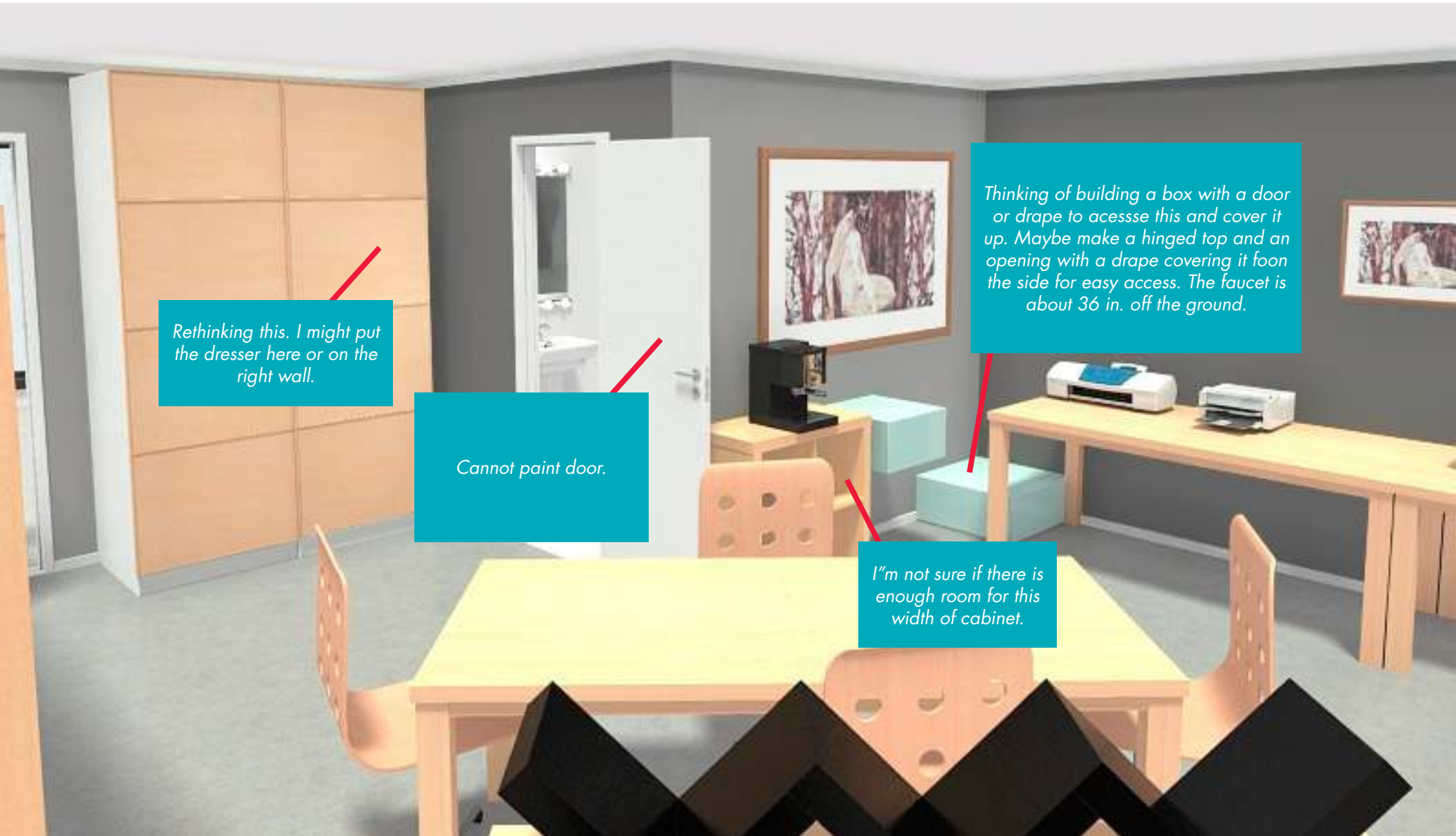

*Rethinking this. I might put the dresser here or on the right wall.*

*Cannot paint door.*

*I'm not sure if there is enough room for this width of cabinet.*

*Thinking of building a box with a door or drape to access this and cover it up. Maybe make a hinged top and an opening with a drape covering it from the side for easy access. The faucet is about 36 in. off the ground.*





## Studio Furniture

### STORAGE

*I have two of these cabinets that we decided to place in the garage door area as you walk into the studio from the front office. Both would face the same direction and would be backed by a grid shelf.*

*I believe they are the same height. The grid shelf would be blonde.*

*A second grid shelf would go on the opposite side of the studio where the second computer would go.*

*A third but shorter, would go behind the main computer consol and divide the computer from the meeting table.*

*FAR RIGHT: shows the wheels that are available. I've decided to use the IKEA wheels because they make the foot print of the cabinet larger—better for stability. They will go on all five of these cabinets.*

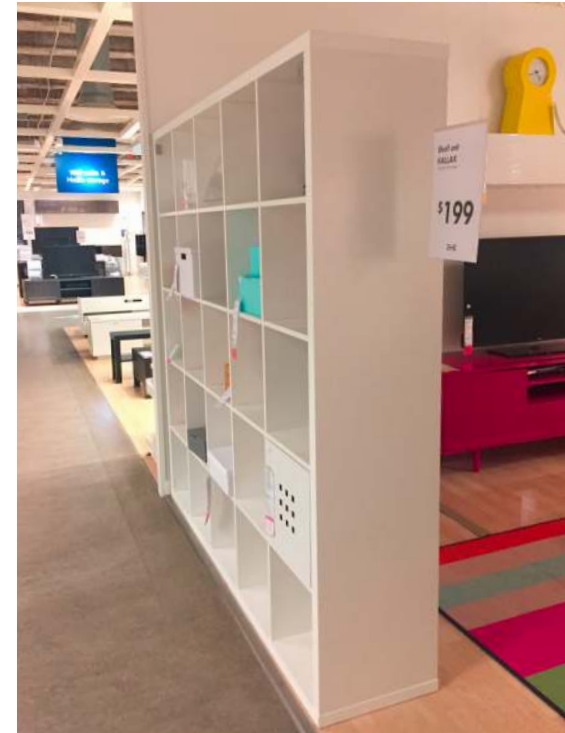

## Studio Furniture

### Seating

*These would be for the meeting table. I would use two black softer chairs for the computer tables.*

*Both computer tables can go high if I want to stand.*



### Storage

*At left are the various available incerts.*

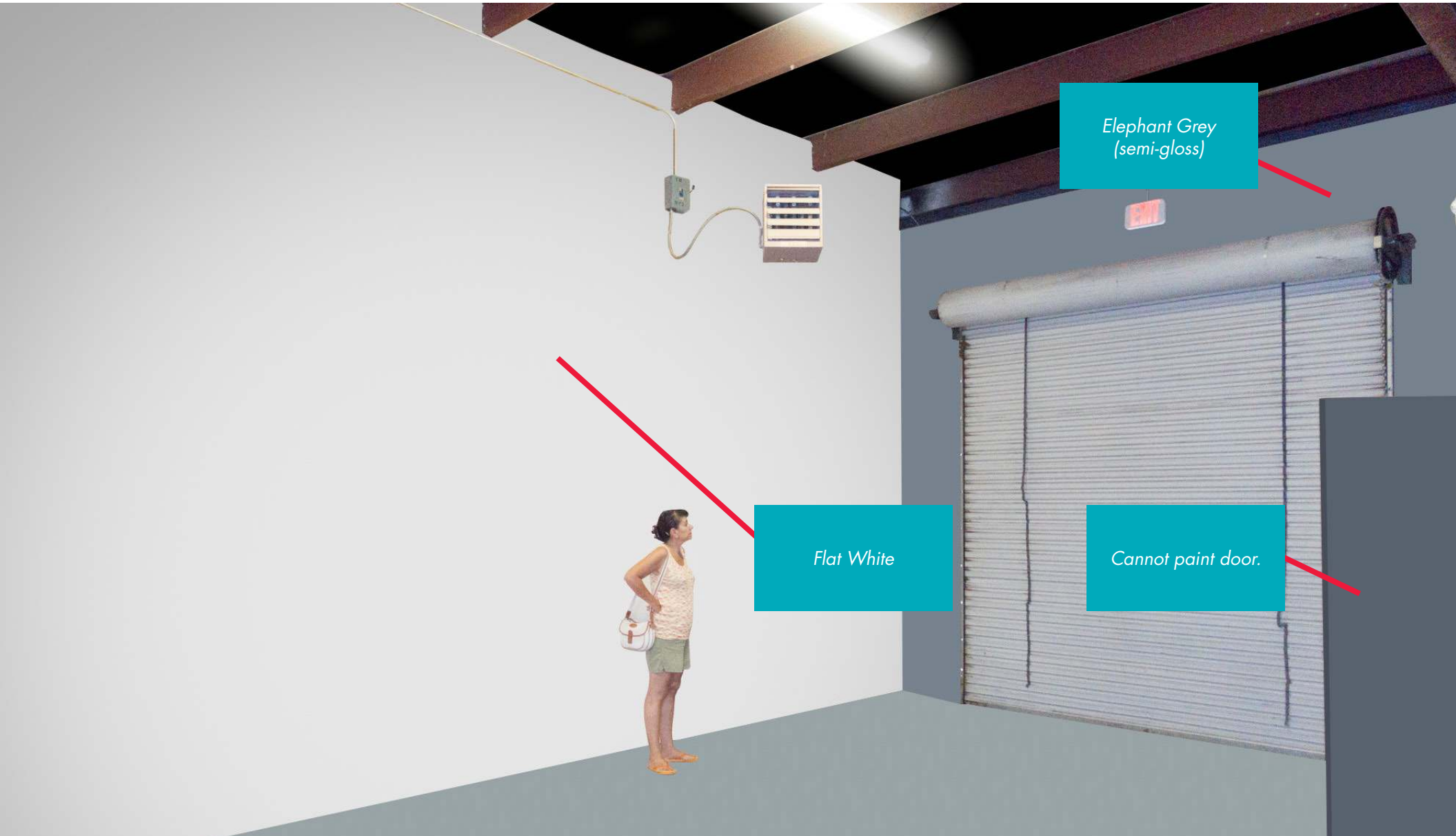

Elephant Grey  
(semi-gloss)

Flat White

Cannot paint door.

*This space is much wider  
than this in real life.*

*Either black or chrome  
metal shelving from  
Home Depot or Lowes*

## Studio Furniture

### **Product Storage**

*These shelf units will be used to store incoming products for photography. I will need 3 of these to start with (two minimum), one for "TO-SHOOT" and one for "COMPLETED"*



### **Shipping & Receiving**

*Purchased workbench from Harbor Freight.*



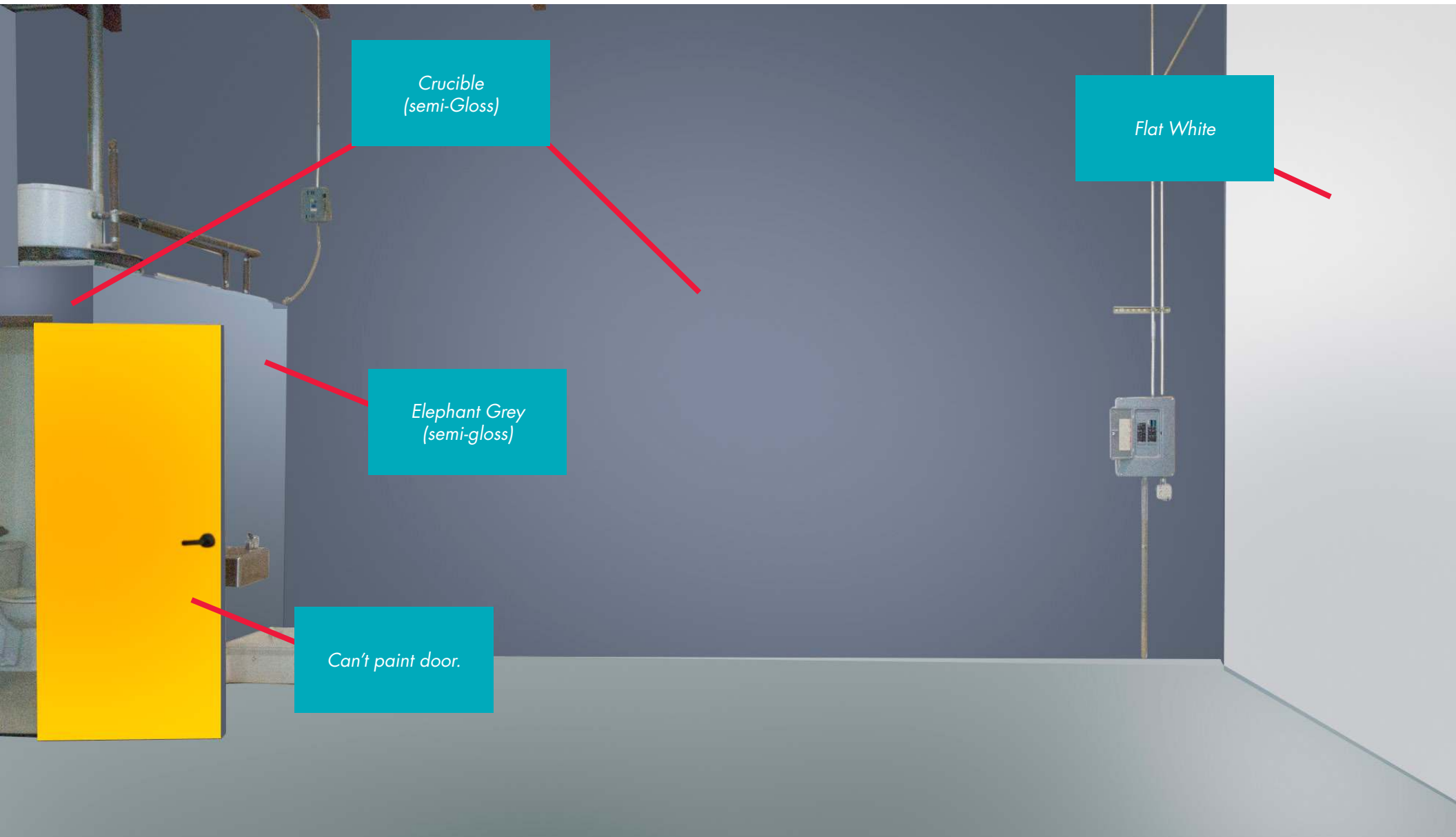

*Crucible  
(semi-Gloss)*

*Flat White*

*Elephant Grey  
(semi-gloss)*

*Can't paint door.*



*Cabinet I need to build to cover the electrical box. May make it wider to house umbrellas, seamless and maybe softboxes.*